

Alternative installation of the Window Cavity Closer

Depending on the location of the weatherboard in relation to the head flashing, a gap may be created. To effectively seal this gap, the cavity closer can be installed backwards. This method also eliminates the need of a cant strip.

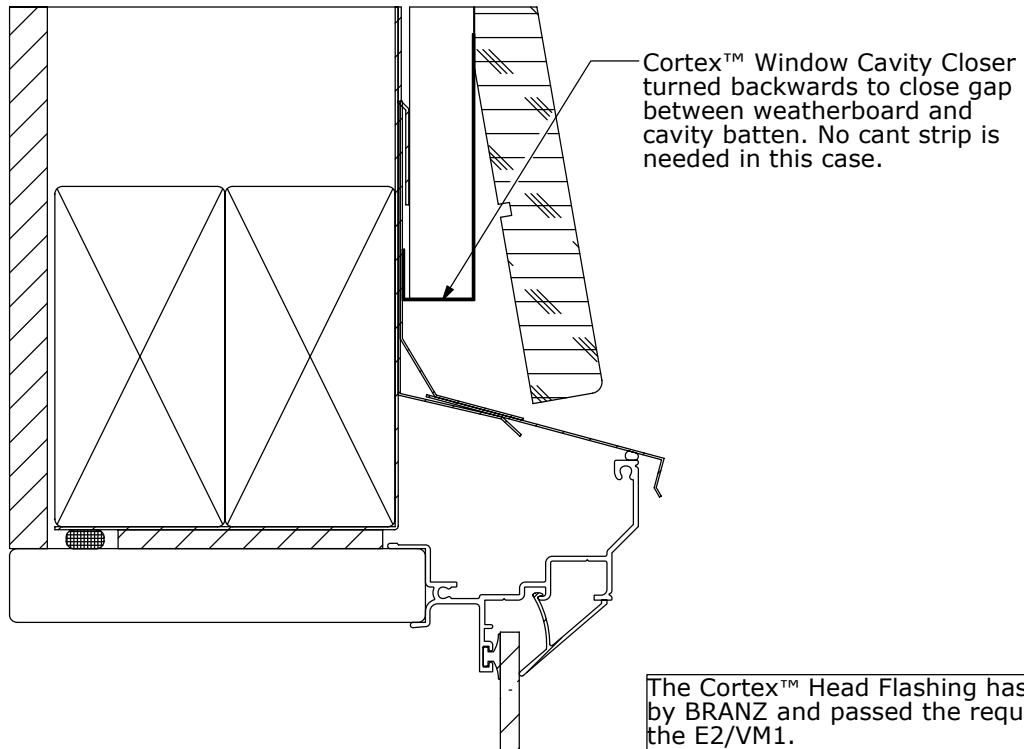

The Cortex™ Head Flashing has been tested by BRANZ and passed the requirements of the E2/VM1.